



**Coil**

Coil parameters	 Line type	 DIN type	<b>Standard voltage:</b> DC12V,DC24V,AC24V,AC36V, AC110V,AC220V,AC380V <b>Scope of voltage:</b> AC±15% DC ±10%	<b>Protection:</b> IP65(DIN40050) <b>Temperature classification:</b> B Class <b>Electrical entry:</b> DIN type,Line type <b>Activating time:</b> 0.05 sec and below
-----------------	--	---	---	--

**VP series(3/2 way) Parameter**

Product images	Model	Port size			Valve type	"□" Model Optional	Same parameters
		IN	OUT	exhaust			
	VP342-□	PT1/4			 Normally opened Rotate the bottom cover by 180° to install different valve types  Normally closed single control 3/2-Way Spring Reset	①Acting Blank: DIN type L: Line type  ②Electrical entry Blank: Internal pilot W: external pilot  ③Voltage DC12V DC24V AC24V AC36V AC110V AC220V AC380V	<b>Fluid:</b> Air(to be filtered by 40um filter element) <b>Operating pressure:</b> 0.15-0.8MPa <b>Proof pressure:</b> 1.2MPa <b>Temperature:</b> -20~70°C <b>Lubrication:</b> Not required <b>Material of body:</b> Aluminum alloy
	VP542-□	PT3/8					

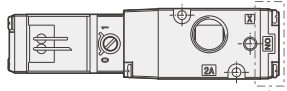
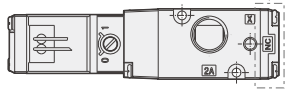
**VP series(3/2 way) External dimensions**

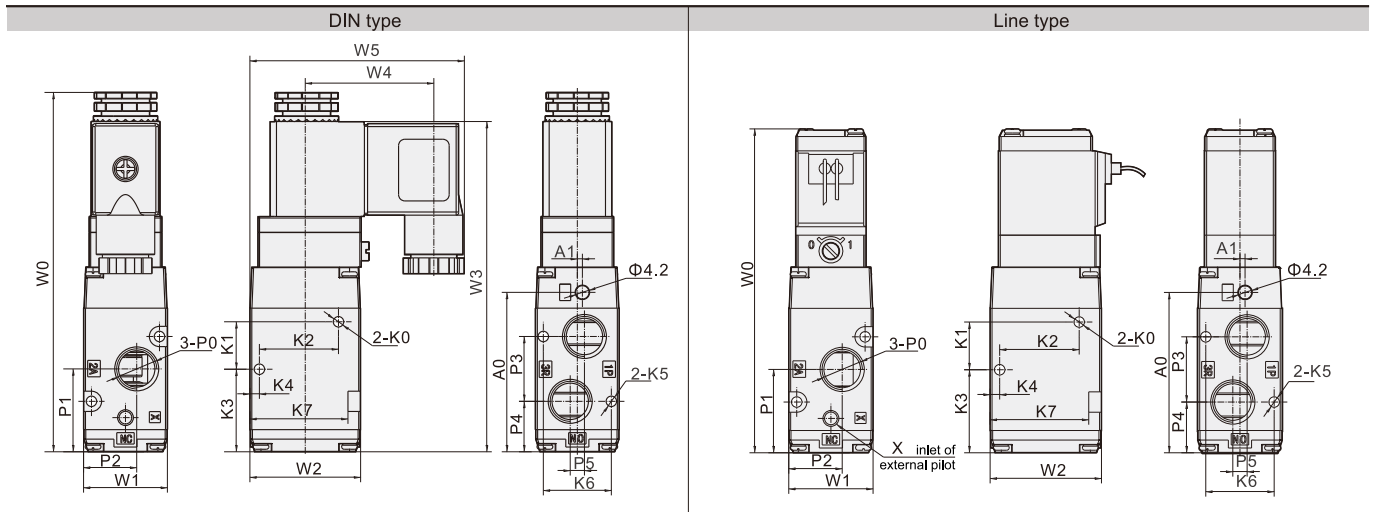

Model	P0	P1	P2	P3	P4	P5	K0	K1	K2	K3	K4	K5	K6	K7	W0	W1	W2	W3	W4	W5	A0	A1	X
VP342	PT1/4	26.2	16.8	20.5	16	4.5	Ø3.3	15	25	26.1	3	Ø3.3	21.5	31	101.8	26.5	35	104.4	40.6	67.8	50.4	1.6	M5×0.8
VP542	PT3/8	41.2	19.5	31	25.7	7	Ø4.3	23.5	31.5	39.5	3	Ø4.3	26	40	129.6	32	45	132.2	40.6	72.8	76.3	2.6	G1/8